



**DROITWICH SPA
HIGH SCHOOL**
AND SIXTH FORM CENTRE

HANDBOOK FOR PARENTS

2020 - 2021



Table of Contents

Attitudes and Values	3-4
Curriculum	5
Extra Curricular Opportunities	6-7
Destinations of Leavers	8-10
Examination Results	11
House System	12-13
Joining the High School	14-15
ICT & Communications	16-17
Lunch and School Catering	18
Paying for Lunches and School Visits	19
School Uniform and Basic Equipment	20-23
Times and Dates	24
The Timetable and Teaching Groups	25
School Map	26



**DROITWICH SPA
HIGH SCHOOL
AND SIXTH FORM CENTRE**

Have a
Mind

to be
Kind

Life. Changing. Learning.



DROITWICH SPA HIGH SCHOOL AND SIXTH FORM CENTRE

In this School we:

Enter and leave every classroom quietly, wearing correct uniform.

Stand behind our chairs and wait to be seated or begin the starter activity provided, if invited to do so.

Follow all instructions from the teacher.

Do not speak when the teacher is talking to the class.

Do not interrupt the flow of a lesson by distracting others.

Raise our hands to ask a question.

Stay seated unless invited to move.

Stand behind our chairs and wait to be dismissed at the end of the lesson.

Life. Changing. Learning.

What follows is an outline of the curriculum. You will find detailed information about the content of each subject in the Curriculum Section of the Website.

In Year 8 students study:

English, Maths, Science, French, German, Geography, History, Art, RE, Computer Science, Design Technology, Food and Nutrition, Music, PSHE (Personal, Social and Health Education) and PE.

In March of Year 8 students are asked which foreign language they want to continue with in Year 9 (or both if they wish) and select two (one if they have chosen both languages) from Art, DT, Food, Music and Drama for study in Year 9.

During Year 9 students make some individual decisions about their mix of courses over the following two years. The choice is wide: the decisions need to be right.

There are many GCSE and vocational Level 2 courses. Our partnerships with local colleges allow some students with vocational ambitions to spend part of their week in a strongly practical environment.

Many of our students choose to return to school after Year 11, becoming members of the Droitwich Spa High School Sixth Form.

This is an opportunity to specialise and gain important qualifications in an environment which bridges the gap between school and the world beyond, between dependence and adulthood. For many of our sixth formers they are the gateway to universities up and down the country.

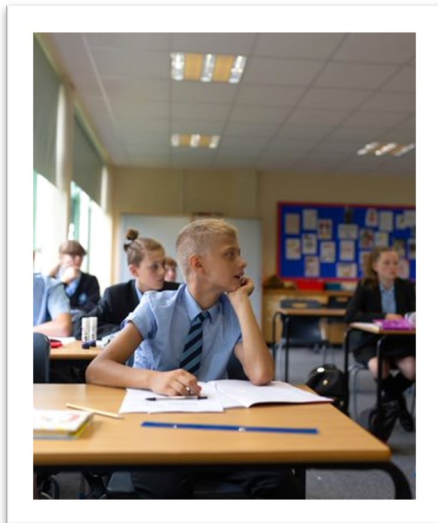
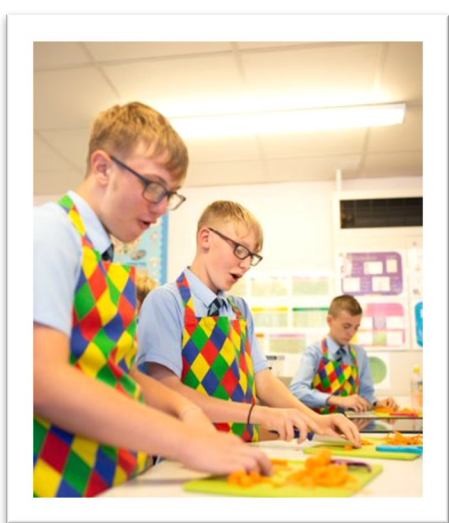

EXTRA-CURRICULAR OPPORTUNITIES

The school community in Droitwich encompasses a great diversity of talents, enthusiasms and ambitions. We aim to match these with a range of extra-curricular activities which offer everyone the possibility of a rich school experience.

Sport is strongly represented in our extra-curricular programme and the school is proud of its tradition of sporting success and individual excellence.

Music and Drama also cast their nets wide. They draw in many students who are already proficient as well as other who simply want to become involved.

Others take part in the various stages of the Duke of Edinburgh's Award Scheme or participate in one of our educational visits at home and overseas.

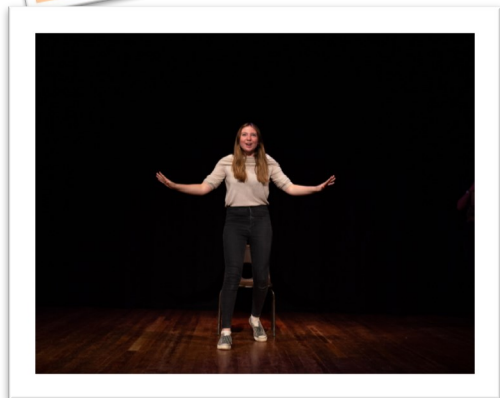

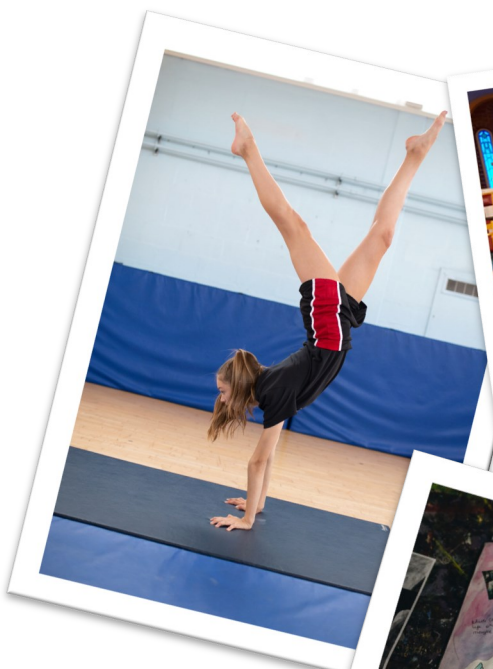

DESTINATIONS OF YEAR 13 LEAVERS 2020

	Destination	Qualification	Start Date
1	University of the West of England, Bristol	Biomedical Science [with Foundation Year]	2020
3	Heart of Worcester College	Art	2020
4	Cardiff University	BA Journalism, Media and English Literature	2020
5	University of Wales Trinity Saint David	MDes Product Design	2021
6	Loughborough University	Industrial Design and Technology	2020
7	The Queen's College, Oxford University	English Language and Literature	2020
8	University of Worcester	Business Management	2020
9	University of Nottingham	Nursing [Adult]	2020
10	University of West of England	Marketing	2020
11	University of Gloucestershire	BSc Professional Policing	2020
12	University of Southampton	Mechanical Engineering with Industrial Placement Year	2020
13	University of the West of England, Bristol	Psychology with Criminology	2020
14	University of Birmingham	Aerospace Engineering	2020
15	University of Birmingham	BSc Physiotherapy	2020
16	Keele University	Geography	2020
17	University of Worcester	Adult Nursing	2020
18	University of Aberystwyth	BSc Biochemistry	2020
19	University of Birmingham	MSc Chemistry with Industrial Experience	2020
20	University of Worcester	BA Sociology	2020
21	University of Swansea	Sport and Exercise Science	2020
22	Royal Holloway University of London	Psychology and Criminology	2020
23	University of Birmingham	Modern Languages [4 years] French and German	2020
24	University of Bristol	Computer Science	2020

DESTINATIONS OF YEAR 13 LEAVERS 2020

	Destination	Qualification	Start Date
25	University of Worcester	Creative Media	2020
26	Cardiff University	Law	2020
28	Manchester Metropolitan University	Economics	2020
29	Employment at Mazak		2020
30	Nottingham Trent University	Biological Sciences	2020
31	De Montfort University	Computer Games Programming	2020
32	University of West of England	BSc Forensic Science	2020
33	Kings College London	International Law	2020
34	Bromsgrove Heart of Worcester College	Art	2020
35	University of West of England	BSc Physiotherapy	2020
36	University of Birmingham	Medicine	2020
37	London School of Economics and Political Science.	BA in Geography	2020
38	University of Worcester	Art	2020
39	Birmingham City University	Food and Nutrition BSc	2020
40	University of Manchester	English Literature	2020
41	UCFB Manchester	Football Business and Marketing	2020
42	University of Worcester	Sport Development and Coaching	2020
43	Plymouth University	Primary and Outdoor Education	2020
44	Cardiff University	History	2020
45	University of Worcester	Sports Development and Coaching	2020
46	Cardiff Met University	Product Design	2020
47	Swansea University	Geography	2020
48	University of Sheffield	Modern Languages and Cultures	2020

DESTINATIONS OF YEAR 13 LEAVERS 2020

	Destination	Qualification	Start Date
50	University of Bristol	Mathematics	2021
51	Nottingham Trent University	BA Economics	2020
52	University of Worcester	BSc Physical Education and Coaching Science	2020
53	University of Worcester	BSc Biology	tbc
54	University of the West of England, Bristol	Digital media	2020
55	University of Gloucester	Sport and Business Management	2020
56	University of West of England	BSc Forensic Science	2020
57	Cardiff University	Ancient and Medieval History	2020
58	De Montfort University	Game Art	2020
3 & 59	Police application pending		tbc
60	University of Worcester	BA History	2020
61	University of Worcester	Business Studies	2020



Year 13 Class of 2020

EXAMINATION RESULTS

In a normal year the school would be displaying the results achieved by students at GCSE and at A level. 2020, as is very widely known, was not a normal year for external exams. We are therefore directing anyone interested in our current performance to the Government's summary and analysis of our 2019 results. This can be found here:

<https://www.compare-school-performance.service.gov.uk/school/136927/droitwich-spa-high-school-and-sixth-form-centre/secondary>



**GCSE RESULTS
DAY 2019**

THE HOUSE SYSTEM

On joining the High School every student becomes a member of one of five houses and will remain a member for the duration of his/her time at DSHS.

There are many competitions and other opportunities to earn points for the house. Students are also encouraged to take on leadership roles within each house. Tutor groups have Captains who contribute to the House Council and each House has up to four students who act as House Captains or Vice Captains.



MRS MUGRIDGE

BULMAN HOUSE

Bulman House is named after Dr Jenny Bulman, who has lived locally for many years. Her work with other volunteers has done much to support people in this county. Most notably this has been through the creation of St Richard's Hospice, initially run from Droitwich and now a greatly valued Worcestershire institution.



MR WARD

D'OLIVEIRA HOUSE

D'Oliveira House is named after Basil D'Oliveira, who spent the early part of his life in South Africa before moving to England and settling in Worcester. As a cricketer he was not only highly successful when he played for the county and for England, he also played a significant part in bringing about peaceful change in South Africa.



MR KIRK

PARKS HOUSE

Parks House is named after Rosa Parks, the American woman whose simple gesture became an inspiration for the American civil rights movement in the middle years of the last century. Her refusal to give up her seat on a bus in Alabama stood as a symbol for those who wanted to bring racial segregation to an end.



MR QUINEY

ROWLING HOUSE

Rowling House is named after JK Rowling, who was born in Bristol but grew up in Gloucestershire. She is a British novelist best known for writing the Harry Potter fantasy series.



MR HOOK

WINSLOW HOUSE

Winslow House is named after Edward Winslow, the Droitwich man who sailed with his wife on the Mayflower and was prominent among the Pilgrim Fathers. He was among the first founders of the settlements that eventually became New England and went on to become the core of the United States.

JOINING THE HIGH SCHOOL

Three tasks underlie much of our work in the early weeks of Year 8. We have to help all of our new students settle into a new environment, whether they join us as part of a friendship group or come to us from outside our normal catchment area.

We aim to make our expectations clear from the beginning. We want all of our Year 8 to realise that we expect high standards of behaviour, dress and commitment to work.

We want to recognise, as quickly as we can, students who are going to need extra help in some area of their work. We are also alert to those who will need more difficult work if they are to be fully stretched.

Every member of the school belongs to a tutor group. Each tutor group belongs to one of the five houses. Students remain within the same house throughout their time at the school.

Year 8, however, also has a Head of Year. This is Mrs Elizabeth Whitehouse. Her role is to oversee the transition into the High School. She should be your first point of contact, either by phoning 01905 774421 or emailing her directly at:

whitehousee@droitwichspahigh.worcs.sch.uk

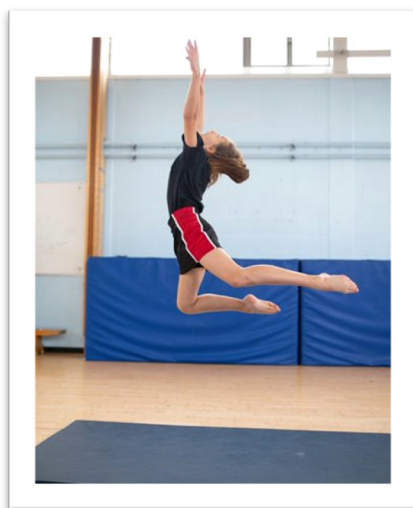

FACES FOR NEW STUDENTS TO GET TO KNOW

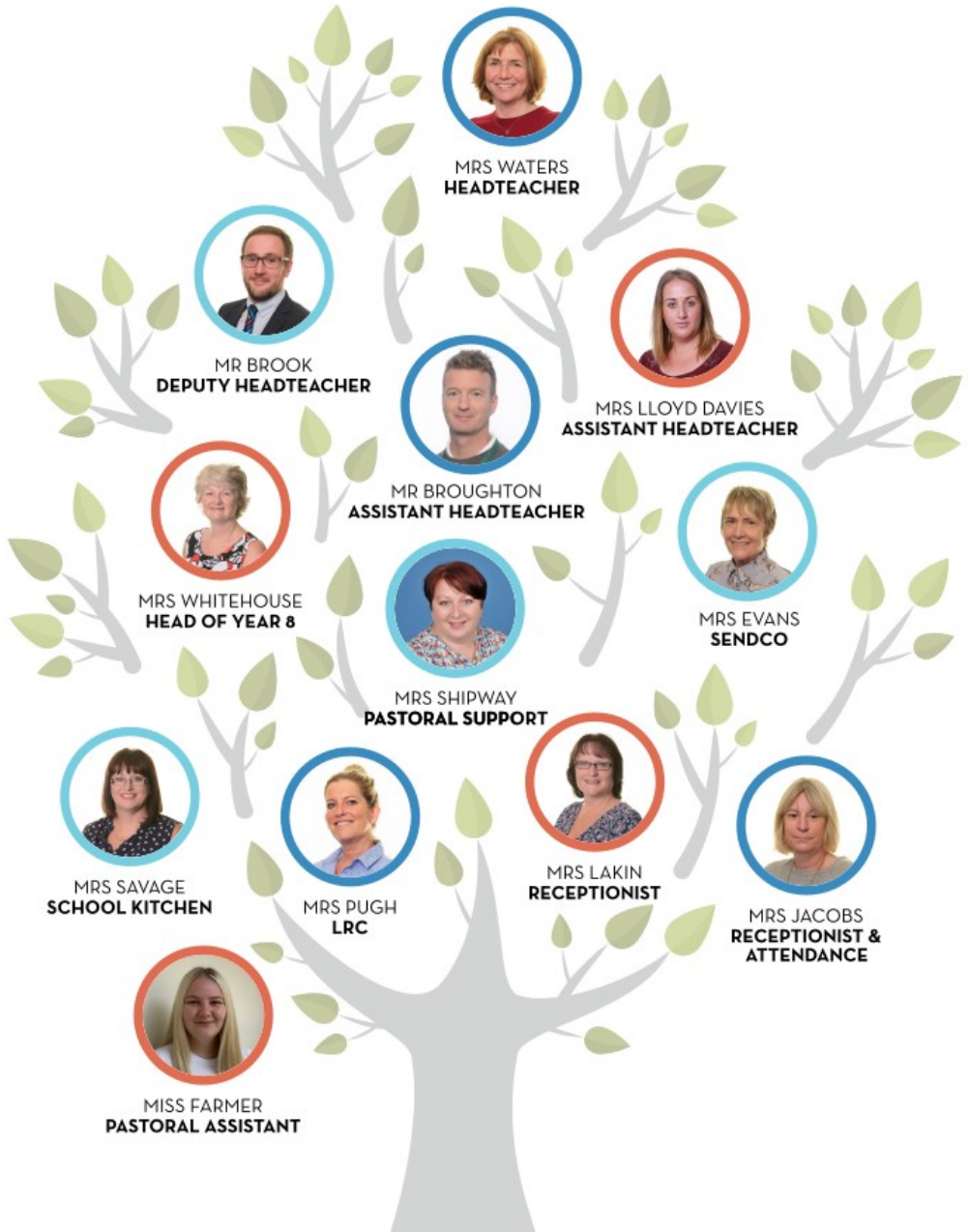

ICT & COMMUNICATIONS

STUDENTS

All students are given an Office 365 account. This means that they have:

- a school email address that can be accessed on any device
- a school Microsoft OneDrive (where they store their documents so they can be accessed on site but also offsite on any device)
- the ability to use the web versions of Word, Excel, PowerPoint etc. on any device
- the ability to download, without charge, the latest version of Microsoft Office on to personal devices

Students are shown how to access this account during their first few ICT lessons.

Students also have an app that allows them to:

- view their timetable
- see what homework they have been set and when it is due in
- see how many positive reward points they have earned (and from where)
- Convert their reward points into treats such as a sweet treat, free item from the café, Nando's voucher
- see a copy of their school report
- Check on their school attendance

In addition, students can access the DSHS Launchpad, which is our intranet site. Through this they can access the shared drives from each department, where there are resources such as extra reading, and past papers.

PARENTS

We have completely redesigned our website (search for Droitwich Spa High) to make it more useful for parents. We hope that everything you need is on the website or in this Handbook. If there is something you can't find please contact us.

We will normally send our communications home via email. Please check your welcome letter carefully—if the email address is incorrect or missing (or you would like to change it) please let us know without delay by calling us on 01905 774421. If we do have incorrect details it is likely you will miss important communications. If, in September, you are not receiving the school newsletter via email (normally weekly) then it is likely you are missing other letters home too.

All of our student information is stored in a system called Arbor. Parents are sent details (via email) of how to log in to the Parent Portal of Arbor or download and log in to the Arbor app.

In the Arbor Parent Portal (or App) you are able to:

- ensure that the parent/guardian/emergency contact details we have on file are correct and update them if necessary
- add/update medical conditions, allergies and information about your child's GP
- give consents for first aid, using biometric information etc.
- give consents for school visits / clubs as they occur
- view your child(ren)'s timetable
- view your child(ren)'s attendance
- view your child(ren)'s school reports

You can also:

- view your child(ren)'s homework
- view your child(ren)'s praise points
- book Parents' Evening appointments
- pay for school visits

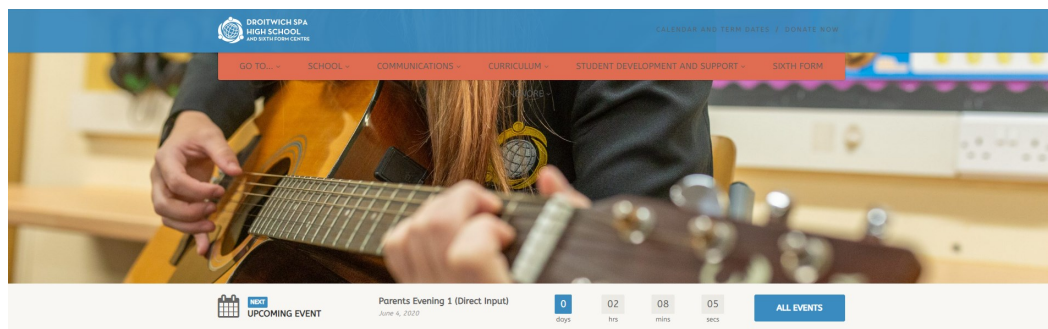

SOCIAL MEDIA

We love to share our good news in the weekly newsletter but we also use our School Facebook and Instagram to share information, especially when we want to do it quickly or when there are many pictures / video clips.



<http://www.facebook.com/droitwichspahigh>



<http://instagram.com/dshsinsta>



LUNCH AND SCHOOL CATERING—THE BIG APPLE

Our own team provides good quality food and drink choices for our students. We pride ourselves on our friendly service and the quality of our food.

Students can enjoy a range of healthy and popular food at breakfast, breaktime & lunchtime, which complies with the School Food Plan and School Food Standards Regulations.

Our current menus and price list are on the school website under School Catering. Allergen information is published against all items.



The food offer is as follows:-

- hot main meal or hot vegetarian main meal
- meat free Mondays
- tasty snack choices
- snack meal in a box or a pot
- smart food hot pasta with sauces
- jacket potatoes with fillings
- sandwiches, wraps & baguettes
- salad pots & pasta pots
- fruit and home-made yogurt
- home-made cakes and cookies
- cold drinks and ice-creams

We have maintained a 5 star Food Hygiene Rating since inspections began in 2010. The School Canteen is a totally cashless operation. We use a dual recognition biometric and pin system for students to purchase their food items. The system uses thumb print recognition technology to take measurements of the thumbprint, but in a way that does not allow a complete image to be stored or reconstructed.

We need to have your permission before taking the necessary thumb scan on the first day of term. If we do not receive it a pin number will be provided.

PAYING FOR LUNCHEAS AND SCHOOL VISITS

Parent Pay is the system which allows you to make payments online for school meals, school visits, revision guides, workbooks, D of E expeditions, theatre tickets and the Prom.

If you are to pay for any of these activities for your son or daughter you will need to have a Parent Pay account. Information about how to set up a Parents Pay account is sent to the home address of all new members of Year 8. Even if you had a Parent Pay Account at a previous school you will still need to set up a new account for Droitwich Spa High School. If you have more than one child at our school or children at other Parent Pay schools, you can create a single account login for all your children.

Parent Pay offers you the freedom to make payments whenever it is convenient to you. No card details are stored on any part of the system. Your secure online account will be activated with a unique username and password. Parent Pay holds a payment history which you can view at a later date. Once you have set up your individual account you can begin to make online payments without delay.



SCHOOL AND PE UNIFORM 2020/21

We want to be clear to all students and parents that the following list of uniform items is intended to be exactly that – uniform. It does not include fashion or designer items, which are not acceptable in our school.

GENERAL INFORMATION

1. There are restrictions on **jewellery**. Students are only allowed one discreet necklace or bracelet, one small signet ring and one plain stud or small sleeper in the lower part of each ear lobe. No other **piercings, ear stretchers** or jewellery are allowed.
2. **Smart watches** are not allowed.
3. Hairstyles should be appropriate for studying in school, without extremes of style, cut or colour. We are mindful of changes in fashion but a “Number 1” hair-cut or shorter is not acceptable. Styles where lines or shapes are cut into the hair, or where parts of the head are shaved are not acceptable. Hair which has been dyed or streaked with unnatural colours (where there are two or more distinct colours that form an obvious contrast) is not permitted. Long hair in boys or girls needs to be tied or clipped back so that teachers are able to see students’ faces.
4. Discreet **make up** is permitted. Light foundation and a small amount of mascara are allowed. Make up should not exaggerate features e.g. eyebrows and excessive/obvious contouring. Nail varnish, nail extensions, false nails and false eyelashes are not allowed. Only modest use of fake tanning products is acceptable.
5. **Hats** should not be worn in school buildings.
6. Scarves must be plain and either black or navy blue. Football or fashion scarves are not allowed.
7. **Hoodies, tracksuit or sweatshirt type tops** may not be used as a substitute for a coat and will be confiscated. Students may wear a hoodie that has the school logo on during PE (see PE uniform).

Please see following pages for itemised uniform lists for boys and girls (including for PE).

Items marked with a * are only compulsory for new starters from September 2019 onwards.

CONTACT DETAILS FOR RETAILERS

Ace Essentials
57 High Street
Droitwich Spa
WR9 8EP
Tel: 01905 772652

School Togs
31 New Street
Worcester
WR1 2DP
Tel: 01905 28658

GIRLS' SCHOOL UNIFORM

GIRLS' PE UNIFORM

Sky blue blouse with open neck reverse collar (with which no tie is necessary).

Available from ACE Essentials and School Togs and many other high street retailers.

Black pleated skirt, which must be no shorter than just above the knee.

Available from ACE Essentials and School Togs and other high street retailers (see appendix).

OR

Black conventional school trousers (not pictured).

Jeans are not allowed. Very tight trousers are also not allowed.

Available from ACE Essentials and School Togs and other high street retailers (see appendix).

Black school blazer with school badge and pocket trims embroidered in house colour*

Available from ACE Essentials

OPTIONAL (not pictured): Black V-neck jumper with school badge.

No other jumpers or cardigans are allowed.

Available from ACE Essentials and School Togs and many other high street retailers.

Navy blue, dark grey or black below the knee socks OR un-patterned black or natural tights.

Black traditional/conventional 'school type' shoes. No trainers or boots (including industrial protective type) are permitted. Specifically, no black canvas shoes/pumps should be bought as they are not allowed.



Black polo shirt with school badge embroidered in house colour*

Available from ACE Essentials

Black gym leggings with house colour flash at bottom of leg.

Available from ACE Essentials

OR

Black and red skort**

Available from ACE Essentials and School Togs

OR

Black shorts with school logo (not pictured - see boys' uniform for info)

OPTIONAL (not pictured)

Black hoodie with school logo

Black and red rugby shirt

available from ACE Essentials and School Togs-

Alternatively, girls may wear a plain black base layer (long or short sleeved) under their polo shirt.

Trainers (no black soles)

White ankle or trainer socks

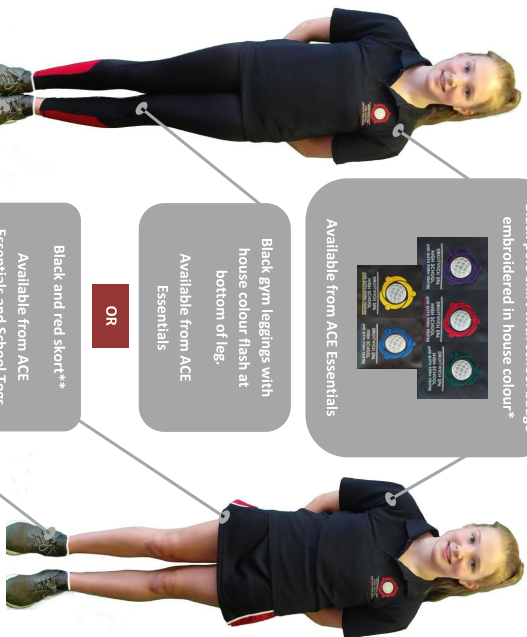

BOYS' SCHOOL UNIFORM



Blue striped clip-on school tie.
Available from ACE Essentials and School Togs

Sky blue conventional style school shirt (with long or short sleeves).
Available from ACE Essentials and School Togs and other high street retailers (see appendix).

Black conventional 'school type' trousers.
Jeans are not allowed. Very tight trousers are also not allowed.
Available from ACE Essentials and School Togs and other high street retailers (see appendix).

Black traditional/conventional 'school type' shoes. No trainers or boots (including industrial protective type) are permitted. Specifically, no black canvas shoes/pumps should be bought as they are not allowed.

Black school blazer with school badge and pocket trims embroidered in house colour*



Available from ACE Essentials

OPTIONAL (not pictured):
Black V-neck jumper with school badge.

No other jumpers or cardigans are allowed.
Available from ACE Essentials and School Togs and other high street retailers.

Navy blue, dark grey or black socks.

BOYS' PE UNIFORM



Black polo shirt with school badge embroidered in house colour*



Available from ACE Essentials

White trainer or ankle socks
AND (not pictured)

Black football/rugby socks (what is required at a given time of year will depend on the sport being played)

Black shorts with school logo
Available from ACE Essentials and School Togs

Trainers (no black soles)
AND (not pictured)
Studded football boots

OPTIONAL (not pictured)

Black hoodie with school logo
Black and red rugby shirt

available from ACE Essentials and School Togs.

Alternatively, boys may wear a plain black base layer (long or short sleeved) under their polo shirt.



What are the seven basic pieces of school equipment you must carry?



PEN AND A SPARE
PENCIL AND A SPARE
RUBBER
RULER
CALCULATOR
SCHOOL BAG



PENCIL CASE (CLEAR ONE FOR EXAMS)



TIMES AND DATES

THE SCHOOL DAY

(During the COVID crisis we have modified the arrangements for our school day. The timings show may not be permanent but we shall continue to follow them until further notice.)

08:50	Lesson 1
09:50	Lesson 2
10:50	Break
11:10	Lesson 3
12:10– 13:40	Lesson 4/Lunch
13.40	Lesson 5
14:40	Tutor Time/Assembly
14:50–15:00	End of School Day

TERM DATES (2021- 2022)

Autumn Term 2021

Thursday 2nd September	INSET Day–School Closed to Students
Friday 3rd September	INSET Day–School Closed to Students
Monday 6th September*	School Opens for Students [8:50 am]
Friday 22nd October	School Closes for Students [3:20 pm]
Monday 1st November	School Opens for Students [8:50 am]
Thursday 26th November	INSET Day–School Closed to Students
Monday 29th November	INSET Day– School Closed to Students
Friday 17th December	School Closes for Students [1:25 pm]

Spring Term 2022

Tuesday 4 th January	INSET Day– School Closed to Students
Wednesday 5th January	School Opens for Students [8:50 am]
Friday 18th February	School Closes for Students [3:20 pm]
Monday 28th February	School Opens for Students [8:50 am]
Friday 8th April	School Closes for Students [3:20 pm]

Summer Term 2022

Monday 25 th April	School Opens for Students [8:50 am]
Monday 2nd May	May Bank Holiday [School Closed]
Friday 27 th May	School Closes for Students [3:20 pm]
Monday 5 th June	School Opens for Students [8:50 am]
Friday 22nd July	School Closes for Students [1:25 pm]

* NB: the arrangements for the first day of school will be confirmed closer to the time, particularly with regard to where new Year 8s should report to on their first day.

THE TIMETABLE AND TEACHING GROUPS

SETTING / GROUPS

Students will be placed into four different types of groups or sets across the week. Where a Middle School has recommended that certain students are kept apart we have done this across all four types of grouping.

1. Tutor Group. Students are in this grouping for tutor time only. The groupings are entirely mixed ability and we prioritise social preferences as much as possible, whilst also making sure that new starters join the same house as their elder siblings.
2. Core Set. Students are in this set for English, Maths, Science, Languages, Geography and History, RE, and Computer Science. The whole year group is split (arbitrarily)* into Left and Right. Then, in each side of the year group, there will be five sets. D and R are for students who have high prior attainment. W and C are our middle sets and then H or A are as small as we can make them in order to allow more individual support for students who have previously struggled with academic work.
3. Practical and PSHE Set. Students are in this set for Design Technology, Food and Nutrition, Music and Personal, Social and Health Education (PSHE). The groups are mixed ability and are smaller so that they can safely work in practical settings. Smaller groups also allow for more personal conversations and discussions in PSHE.
4. PE sets. Students are in gender groupings.

*in an academic year where we have been made aware we have some exceptional mathematicians coming to us, we do endeavour to put them in the same side of the year group so that we can keep them together and stretch them as much as possible.

LESSONS (HOURS) PER FORTNIGHT

The H and A sets have a slightly different mix of lessons but for the majority the hours per fortnight are as follows:

English	6
Maths	6
Science	6
French	4
German	4
Geography	3
History	3
Art	2
RE	2
Computer Science	2
Design Technology	2
Food and Nutrition	2
Music	2
PSHE	2
PE	4

SCHOOL MAP

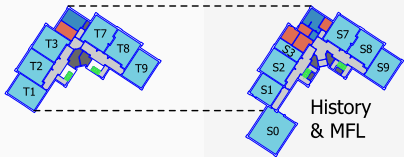

Key

Classroom

Office

Toilets & Changing Rooms

Corridor

Stairs

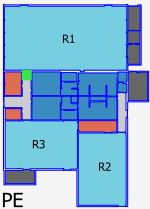

Geography Business

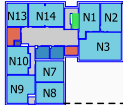

HE



Music



RE

ICT & English

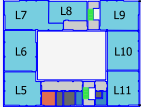

English



Maths



Heads of Houses & Pastoral

Sixth Form

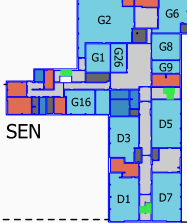

SEN



Science

Science



Staff Room F20

Reception



Learning Resource Centre

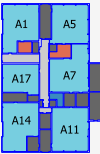

Art, Design & Technology



Second Floor

First Floor

Ground Floor

